

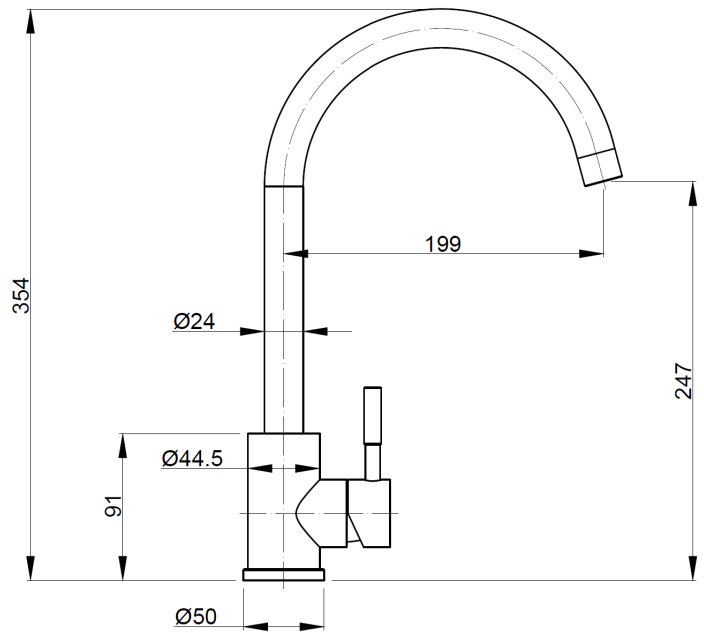

XPO – XFIT100SKM / XFIT100SKM_CP /XFIT100SKM_PS
 XFIT100SKM_MB



Note: Drawings are not to scale and are for reference only. Specifications and sizes can be changed by the manufacturer without notice. Refer to physical unit prior to installation.

Product Specifications

Base Material	304 Stainless Steel	
Finish	Satin / Chrome Plated / Matt Black	
Installation	XpressFit Top Mount	
Height	354mm	
Projection	199mm	
Features	Cool start handle	
WELS Rating	4 star water efficiency, 7.5L per minute, Reg. T35487	
Cartridge Size	35mm	
Warranty	2 years parts and labour, 15 years replacement on cartridge and PEX inlet hoses	